



## **CHSC Green Team**

New University Circle Headquarters  
Recycling Program



November 2009



## CHSC Green Team Single Stream Recycling Flow Plan



### Step One

Daily - Each staff person or visitor uses recycled material collection bins located throughout the building.

- Public container located on the 1st floor in the vending room area.



### Step Two

Daily – At the end of each day, staffers empty their recyclables into large 32-gal recycle containers located on the 1st, 2nd, and 4th floors.



### Step Three

Daily - Cleaning crew empties large 32-gallon containers, along with 3 stream container, into large recycle bin located outside.



### Step Four

Weekly or Bi-monthly - Waste Management takes away recycled materials.





# Recycling Program

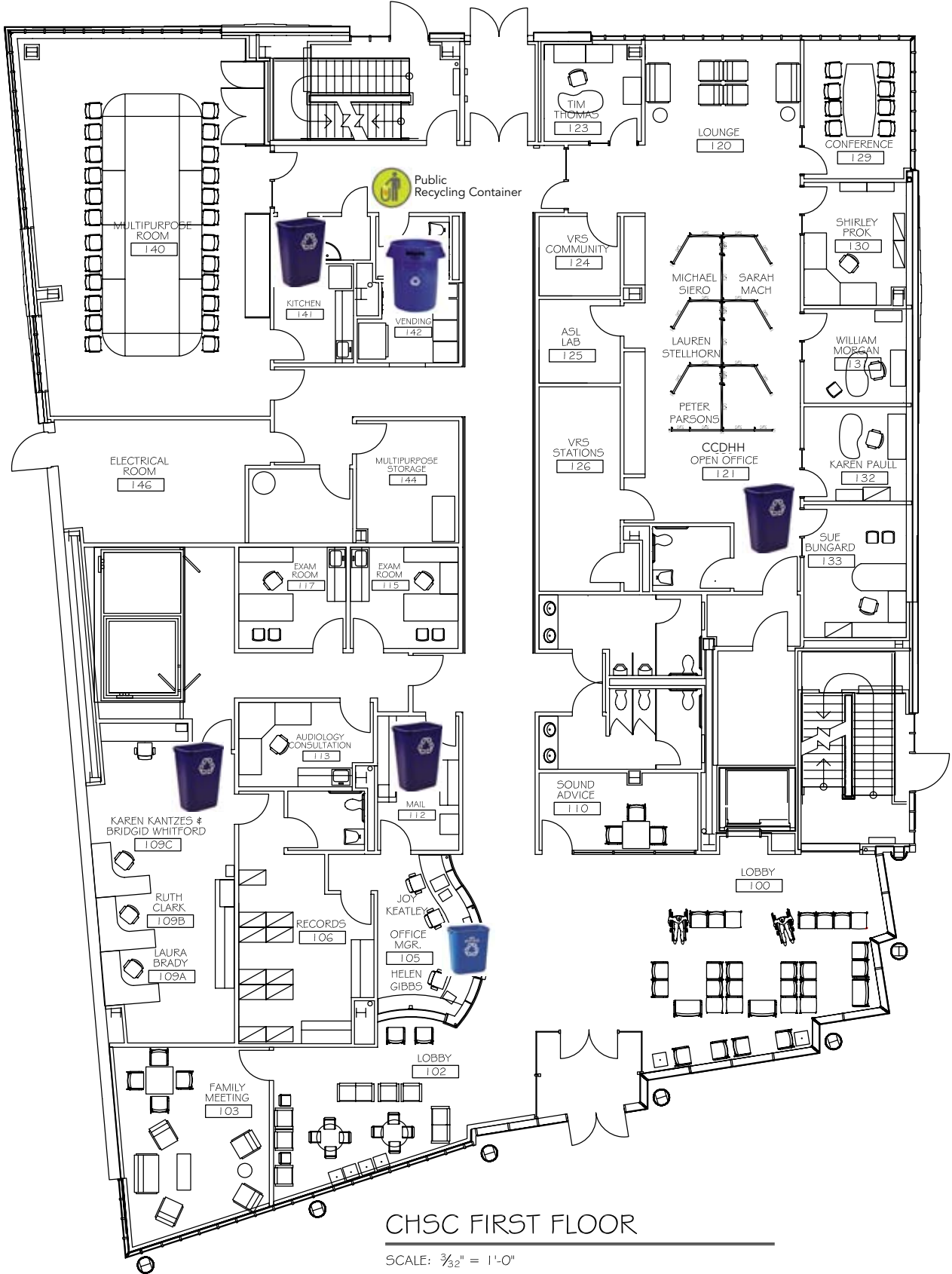

## Recycling Container Key





# Recycling Program

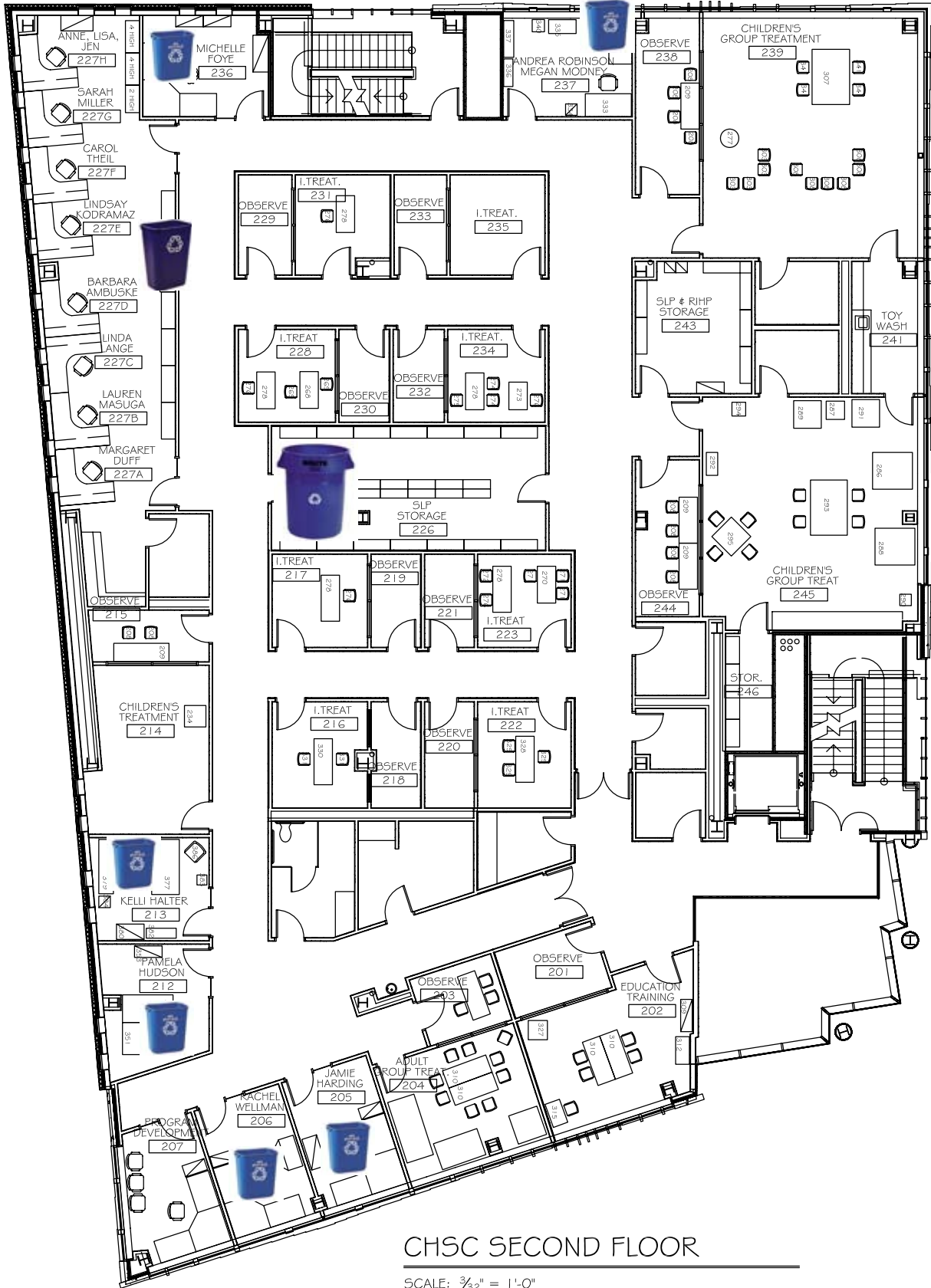

## CHSC SECOND FLOOR

SCALE: 3/32" = 1'-0"

### Recycling Container Key



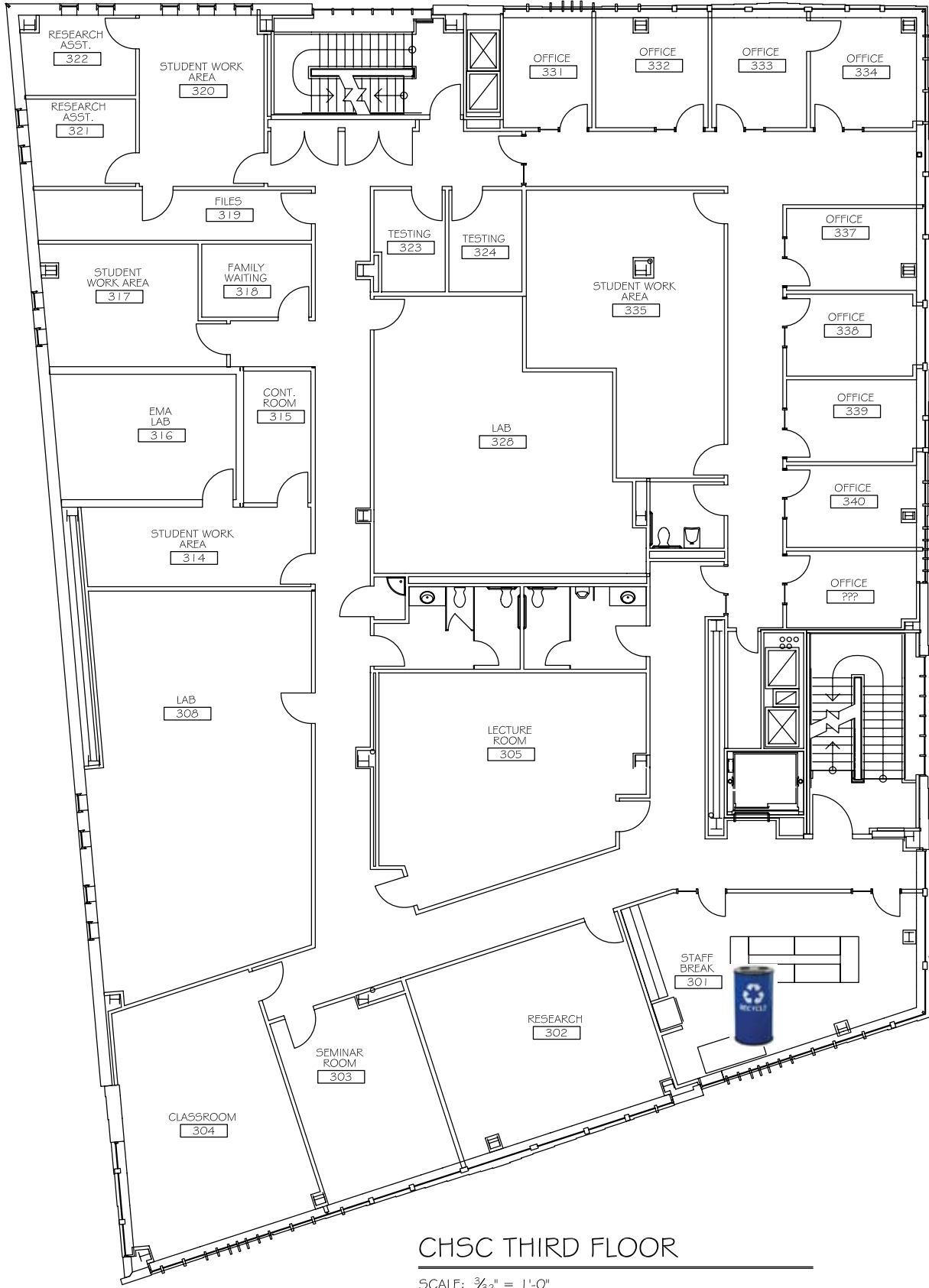

**Recycling Container Key**





CHSC FOURTH FLOOR  
SCALE: 3/32" = 1'-0"

**Recycling Container Key**





### CHSC Recycle Container Locations:

Floor	Room No.	Type	Quantity
1	105 Client Intake	13 Quart	1
1	109 Audiology Lab	41 Quart	1
1	112 Mailroom #1	41 Quart	1
1	121 CCDHH Open Area	41 Quart	1
1	141 All-Purpose Room Kitchen	41 Quart	1
1	142 Vending	32 Gallon	1
2	226 SLP Storage Room	32 Gallon	1
2	227 SLP Area	41 Quart	1
2	Offices	13 Quart	7
3	301 Break/Lunch Room	3 Stream Smiley	1
4	412 Mailroom #2	41 Quart	1
4	416 Storage Room	32 Gallon	1
4	438 Development Work Area	41 Quart	1
4	Offices	13 Quart	12

#### Recycling Container Key



## **Our Mission**

The mission of the CHSC Green Team is to inspire change that reduces CHSC's impact on our environment and generates savings through sensible use of resources.

Recycling | LEED Design | Think Green | Transportation Alternatives